

4

3

2

1

NOTES:

1. AC LINES ARE NOT CURRENT LIMITED WITHIN THIS MODULE. AC LINE CURRENT LIMIT MUST BE PROVIDED WITH EXTERNAL BREAKERS. AC CURRENT SHOULD NOT EXCEED 30 AMPS. P/N OF CONEC INC.
2. PINS ARE USED ONLY IF REMOTE "TEST/RESET" PANEL IS USED. J1 PINS 5, 6, 7, 8, AND 9 ARE INTERNALLY CONNECTED TO J2 PINS 3, 4, 5, 6, AND 7
3. INSTALLATION AND OPERATION: SEE MCC-19-250.
4. LED WILL INDICATE SYSTEM VOLTAGE. GREEN IS 115 VAC, RED IS 230 VAC.
5. TYPICAL FAULT CURRENT SENSITIVITY: 6 - 10mA.
6. UNIT SHOULD BE TESTED PERIODICALLY TO INSURE PROPER OPERATION.
7. P/N OF ITT CANNON.
8. MATING CONNECTOR KIT AVAILABLE AS MCCI P/N: 856003-1 & 856030-1 FOR CONNECTORS J1 & J2 RESPECTIVELY.
9. PIN STATE WILL INDICATE SYSTEM VOLTAGE. FLOATING IS 115VAC, GROUNDED IS 230VAC.

REVISION HISTORY				
ZONE	REV	DESCRIPTION	DATE	DRAWN
4D	A	ADDED PIN DESCRIPTION FOR 115/230 GND OUT.	2/20/2014	AJH

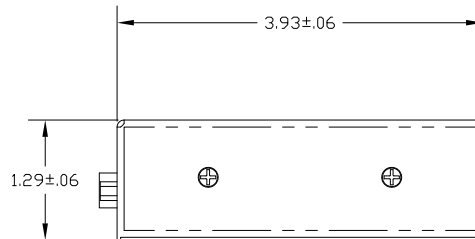
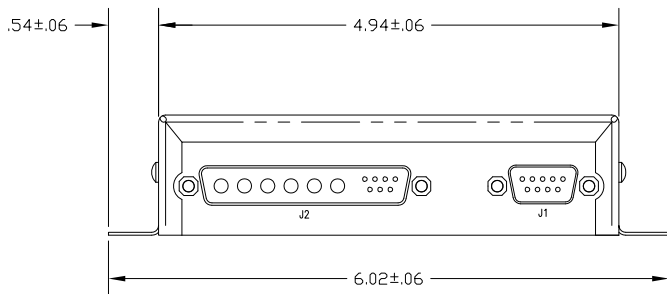
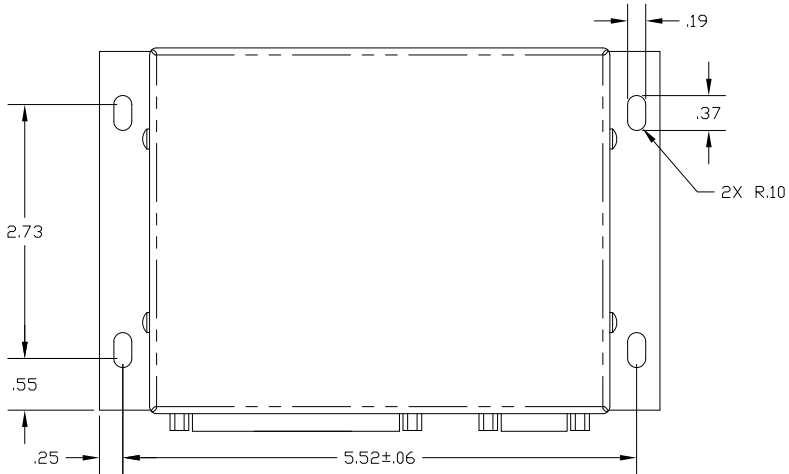
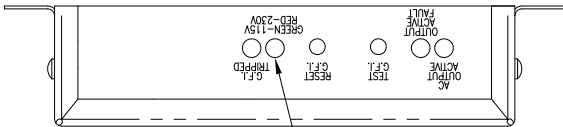

WIRE DESCRIPTION - J1		
CONNECTOR DESCRIPTION		MATING CONNECTOR
PART NUMBER		PART NUMBER (OR APPLICABLE EQUIVALENT)
DEMA9P	CONNECTOR	DEMA9S CONNECTOR
D20418-2	FEMALE JACKPOST	D20419-21 MALE SCREW LOCK BACKSHELL DE20961 CRIMP SOCKET 031-1007-078
PIN	CIRCUIT DESCRIPTION	CIRCUIT TYPE
1	NC	N/A
2	GND	AIRCRAFT GROUND
3	NC	N/A
4	NC	N/A
5	REMOTE "TEST" INPUT	GND INPUT @ 10mA
6	REMOTE "RESET" INPUT	GND INPUT @ 10mA
7	REMOTE "TRIP" INDICATOR OUTPUT	GND OUTPUT @ 50mA
8	REMOTE "ACTIVE" INDICATOR OUTPUT	GND OUTPUT @ 50mA
9	REMOTE "115/230" INDICATOR OUTPUT	GND OUTPUT @ 50mA

WIRE DESCRIPTION - J2		
CONNECTOR DESCRIPTION		MATING CONNECTOR
PART NUMBER		PART NUMBER (OR APPLICABLE EQUIVALENT)
3013W6PCT58N20X	CONNECTOR	3013W6SXK99A10X CONNECTOR
D20418-2	FEMALE JACKPOST	132CI1039X CRIMP SOCKETS, 30A 132CI5019X CRIMP SOCKETS
PIN	CIRCUIT DESCRIPTION	CIRCUIT TYPE
A1	AC LINE (OUTPUT - 30A MAX.)	115 / 230 VAC OUTPUT
A2	AC RTN (OUTPUT - 30A MAX.)	115 / 230 VAC OUTPUT
A3	AC GND (OUTPUT)	115 / 230 VAC OUTPUT
A4	AC GND (INPUT)	115 / 230 VAC INPUT
A5	AC RTN (INPUT)	115 / 230 VAC INPUT
A6	AC LINE (INPUT)	115 / 230 VAC INPUT
1	NC	NA
2	STATIC GROUND	AIRCRAFT GROUND
3	REMOTE "TEST" INPUT	GND INPUT @ 10mA
4	REMOTE "RESET" INPUT	GND INPUT @ 10mA
5	REMOTE "TRIP" INDICATOR OUTPUT	GND OUTPUT @ 50mA
6	REMOTE "ACTIVE" INDICATOR OUTPUT	GND OUTPUT @ 50mA
7	REMOTE "115/230" INDICATOR OUTPUT	GND OUTPUT @ 50mA

THIS DRAWING CONTAINS PROPRIETARY INFORMATION AND IS CONTROLLED DOCUMENT THAT ARE CONFIDENTIAL TO THE MATERIAL SHOULD BE KEPT AS SUCH AND NOT BE LOANED, REPRODUCED, COPIED, OR DISSEMINATED TO ANY ORGANIZATION OR PERSON WITHOUT THE WRITTEN PERMISSION FROM MID CONTINENT CONTROLS, INC.

MID CONTINENT CONTROLS, INC.
901 NORTH RIVER DERBY, KS 67037 (316)789-0088

FINISH: ANODIZE, TYPE II, BLACK MIL-A-8825
MATERIAL: N/A

UNLESS OTHERWISE SPECIFIED: DIMENSIONS ARE IN INCHES. TOLERANCES ARE: .XX = .01 ANGLES ±1° .XXX = .005

DERIVED FROM N/A

SIZE/DRAWN DWG NO. REV
C AJW 106366 A

SCALE 1/1 DATE 6/16/2011 SHEET 1 OF 1

ORDER NO.	DESCRIPTION
106366-1	GROUND FAULT INTERRUPTER, AC ONLY (115/230)

4

3

2

1