

NOTES:

- 1) AC LINES ARE NOT CURRENT LIMITED WITHIN THIS MODULE. AC LINE CURRENT LIMIT MUST BE PROVIDED WITH EXTERNAL BREAKERS. AC CURRENT SHOULD NOT EXCEED 20 AMPS.

P/N OF CONEC INC.

PINS 7, 8, & 9 ARE USED ONLY IF REMOTE "TEST/RESET" PANEL IS USED.

4) FUNCTIONAL DESCRIPTION: SEE MCC-19-167.

5) TEST PER MCC-14-459.

6) TYPICAL FAULT CURRENT SENSITIVITY: 3 - 10mA.

7) UNIT SHOULD BE TESTED PERIODICALLY TO INSURE PROPER OPERATION.

8) WEIGHT: 0.65 lbs.

9) POWER REQUIREMENTS: +28V @ 150mA TYP.

(EXCLUDING LOAD ON +28V TURN ON OUTPUT, PIN 3 OF 15).

P/N OF ITT CANNON.

MATING CONNECTOR KIT AVAILABLE AS MCC1 P/N:

856019-1 & 856018-1 FOR CONNECTORS 1 & 2 RESPECTIVELY.

12) ORDER NUMBER IS 106234-1.

REVISIONS				
ZONE	REV	DESCRIPTION	DATE	DRAWN
D4	A	CHANGED NOTE 5 FROM "TEST PER MCC-14-1300".	07/26/2007	TRH
A3	B	MOVED J1 AND J2 IDENTIFIERS	01/11/2010	TRH

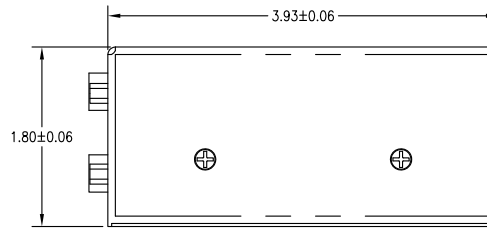
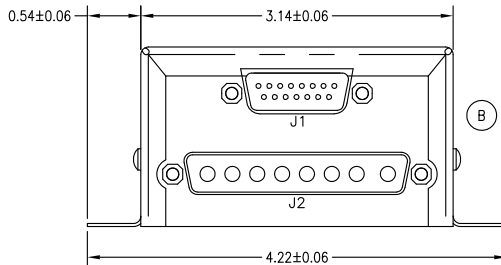
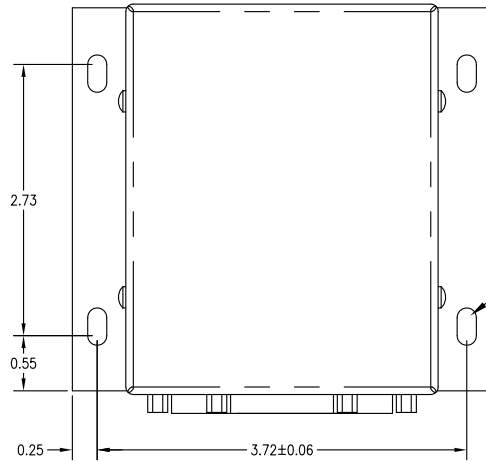
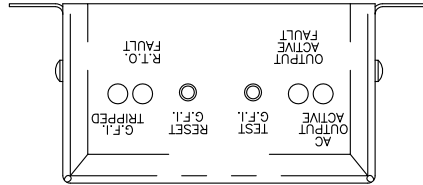

WIRE DESCRIPTION - J1		
CONNECTOR DESCRIPTION	MATING CONNECTOR	
PART NUMBER	PART NUMBER	
MD15M5R5NTO CONNECTOR	DAMAT5S CONNECTOR	
D20418-2 FEMALE JACKPOST	DB20961 BACKSHELL	
	D20419-21 MALE SCREWLOCK	
	D20419-21 MALE SCREWLOCK	
PIN	CIRCUIT DESCRIPTION	CIRCUIT TYPE
1	28VDC	DC SUPPLY VOLTAGE
2	GND	DC RETURN
3	TURN ON	28VDC OUTPUT @ 250mA
4	REMOTE TURN ON	28VDC INPUT @ 10mA
5	TURN ON	GND OUTPUT @ 50mA
6	REMOTE TURN ON	GND INPUT @ 10mA
7	REMOTE "TEST"	GND INPUT @ 10mA
8	REMOTE "RESET"	GND INPUT @ 10mA
9	REMOTE "TRIP" INDICATOR	GND OUTPUT @ 50mA
10	NC	N/A
11	NC	N/A
12	NC	N/A
13	NC	N/A
14	NC	N/A
15	NC	N/A

WIRE DESCRIPTION - J2		
CONNECTOR DESCRIPTION	MATING CONNECTOR	
PART NUMBER	PART NUMBER	
5008W8PX56A30X CONNECTOR	5008W8SX9A10X CONNECTOR	
D20418-2 FEMALE JACKPOST	165X13399X BACKSHELL	
	132C11029X CRIMP SOCKETS	
PIN	CIRCUIT DESCRIPTION	CIRCUIT TYPE
A1	NC	N/A
A2	AC LINE (20A MAX)	115 VAC OUTPUT
A3	AC RTN (20A MAX)	115 VAC OUTPUT
A4	AC GND	115 VAC OUTPUT
A5	AC GND	115 VAC INPUT
A6	AC RTN	115 VAC INPUT
A7	AC LINE	115 VAC INPUT
A8	NC	N/A

THIS DRAWING CONVEYS PROPERTY INFORMATION AND TECHNICAL DATA. THE USER SHALL BE RESPONSIBLE FOR THE PROTECTION OF THIS INFORMATION. SHOULD THE USER BE AWARE OF ANY VIOLATION OF THIS POLICY, PLEASE CONTACT THE DRAWING ORIGINATOR OR THE COMPANY'S LEGAL DEPARTMENT.		MID CONTINENT CONTROLS, INC. (316)789-0088	
FINISH: ANODIZE TYPE II, CLASS 2 BLACK, MIL-A-8625		901 NORTH RIVER, DERBY, KS 67037	
TITLE: GROUND FAULT INTERRUPTER (GFI)			
MATERIAL: N/A	SIZE: C	DRAWN: GBE	DWG NO. 106234
TOLERANCE: ± 0.030" UNLESS NOTED	SCALE: 1 : 1	DATE: 12/14/06	SHEET 1 OF 1