

4

3

2

1

NOTES:

- 1) AC LINES ARE NOT CURRENT LIMITED WITHIN THIS MODULE. AC LINE CURRENT LIMIT MUST BE PROVIDED WITH EXTERNAL BREAKERS. AC CURRENT SHOULD NOT EXCEED 15 AMPS.
- 2) P/N OF CONEC INC.
- 3) PINS 7, 8, & 9 ARE USED ONLY IF REMOTE "TEST/RESET" PANEL IS USED.
- 4) FUNCTIONAL DESCRIPTION / WIRING DIAGRAM: SEE MCC-19-082.
- 5) TYPICAL FAULT CURRENT SENSITIVITY: 3 - 10mA.
- 6) UNIT SHOULD BE TESTED PERIODICALLY TO INSURE PROPER OPERATION.
- 7) WEIGHT: 0.7 lbs.
- 8) POWER REQUIREMENTS: +28V @ 150mA TYP. (EXCLUDING LOAD ON +28V TURN ON OUTPUT, PIN 3 OF 15).
- 9) P/N OF ITT CANNON.
- 10) MATING CONNECTOR KIT AVAILABLE AS MCCI P/N: 856019-1 & 856009-1 FOR CONNECTORS 1 & 2 RESPECTIVELY.
- 11) ORDER NUMBER IS 106104-1 FOR -1 AND 106104-2 FOR -2.
- 12) THE 106104-2 IS TESTED AND VERIFIED TO TRIP WITHIN 30ms WHEN A 30mA FAULT IS PRESENT.

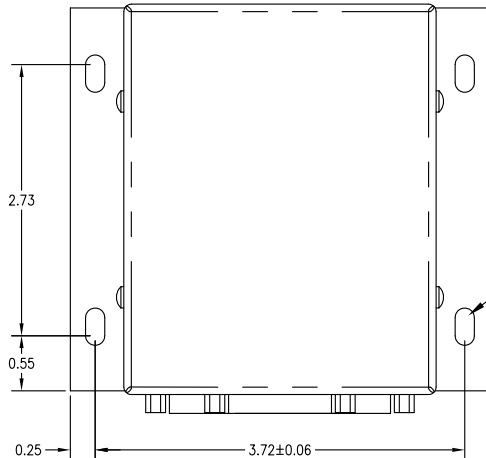
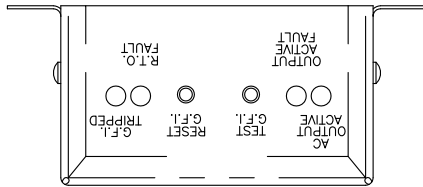

Ø0.193 x .375" slot  
4 plcs

- 1 106104-1
- 2 106104-2

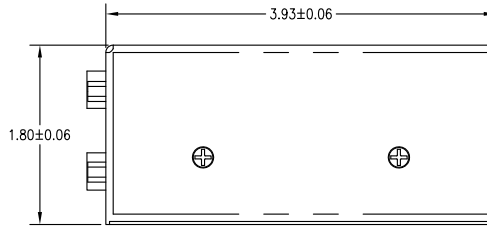
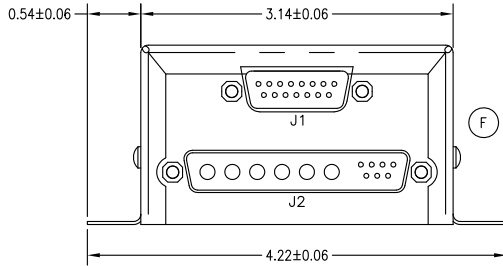

REVISIONS				
ZONE	REV	DESCRIPTION	DATE	DRAWN
ALL	D	1) REDRAWN WITH CHANGES: CHANGED TOLERANCE: WAS .010" DIMENSION CLEANUP TO MATCH DETAIL PARTS INCORPORATED ALL PREVIOUS REVISIONS.	3/13/06	RAH
ALL	E	1) ADDED THE 106104-2 ADDED NOTE 12 ADDED THE -2 TO NOTE 11	6/5/09	TRH
A3	F	1) MOVED J1 AND J2 IDENTIFIERS	1/11/10	TRH

WIRE DESCRIPTION - J1			
CONNECTOR DESCRIPTION		MATING CONNECTOR	
PART NUMBER		PART NUMBER	
DAMA-15P	CONNECTOR	DAMA-15S	CONNECTOR
D20418-2	FEMALE JACKPOST	D20419-21	MALE SCREWLOCK BACKSHELL
DA20961			
PIN	CIRCUIT DESCRIPTION	CIRCUIT TYPE	
1	28VDC	DC SUPPLY VOLTAGE	
2	GND	DC RETURN	
3	TURN ON OUTPUT	28VDC OUTPUT @ 250mA	
4	REMOTE TURN ON INPUT	28VDC INPUT @ 10mA	
5	TURN ON OUTPUT	GND OUTPUT @ 50mA	
6	REMOTE TURN ON INPUT	GND INPUT @ 10mA	
7	REMOTE "TEST" INPUT	GND INPUT @ 10mA	
8	REMOTE "RESET" INPUT	GND INPUT @ 10mA	
9	REMOTE "TRIP" INDICATOR OUTPUT	GND OUTPUT @ 50mA	
10	NC	NA	
11	NC	NA	
12	NC	NA	
13	NC	NA	
14	NC	NA	
15	NC	NA	

WIRE DESCRIPTION - J2			
CONNECTOR DESCRIPTION		MATING CONNECTOR	
PART NUMBER		PART NUMBER	
5013W6PCT56A30X	CONNECTOR	5013W6SXK99A10X	CONNECTOR
D20418-2	FEMALE JACKPOST	132C11029X	CRIMP SOCKETS
PIN	CIRCUIT DESCRIPTION		
A1	AC LINE (OUTPUT - 15A MAX.)		
A2	AC RTN (OUTPUT - 15A MAX.)		
A3	AC GND (OUTPUT)		
A4	AC GND (INPUT)		
A5	AC RTN (INPUT)		
A6	AC LINE (INPUT)		
1	NC		
2	NC		
3	NC		
4	NC		
5	NC		
6	NC		
7	NC		

THIS DRAWING CONTAINS PROPRIETARY INFORMATION AND TECHNICAL MATERIAL THAT ARE THE SOLE PROPERTY OF MID CONTINENT CONTROLS, INC. THIS MATERIAL SHOULD BE TREATED AS CONFIDENTIAL BY ITS RECIPIENT AND SHOULD NOT BE SHOWN OR DISCLOSED TO ANY ORGANIZATION OR PERSON WITHOUT FIRST OBTAINING WRITTEN PERMISSION FROM MID CONTINENT CONTROLS, INC.

Mid Continent Controls, Inc. (316)789-0088  
901 N. River Derby, KS 67037

**GROUND FAULT INTERRUPTER (220)**

FINISH: BLACK ANODIZE

MATERIAL: N/A

TOLERANCE: ±0.030" UNLESS NOTED

SIZE: c DRAWN: DLS DWG NO.: 106104 REV: F

SCALE: 1 : 1 DATE: 07/22/03 SHEET: 1 OF 1

4

3

2

1